

RECOMMENDED PCB LAYOUT
COMPONENT SIDE

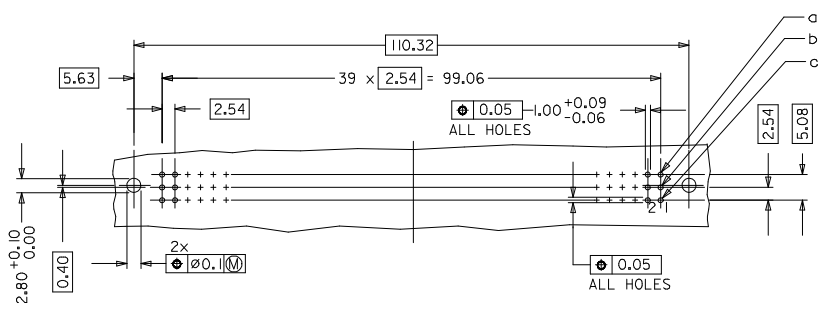

NOTES:

- 1) MATERIALS: THERMOPLASTIC POLYESTER, GLASS FILLED, UL94V-0.
COLOUR: PEBBLE GREY RAL 7032
TERMINAL - PHOSPHOR BRONZE
- 2) FINISH: CONTACT AREA

PERFORMANCE LEVEL 2: SLECTIVE GOLD (Au), THICKNESS = 0.6 MICROMETER,
OVER NICKEL, THICKNESS = 1.25 MICROMETER MIN

PRESS-IN AREA : Au FLASH, OVER NICKEL, THICKNESS = 1.25 MICROMETER MIN OVERALL

WRAP AREA : Au FLASH, OVER NICKEL, THICKNESS = 1.25 MICROMETER MIN OVERALL

TRANSFER PLUGGING AREA :
PERFORMANCE LEVEL 2 : SLECTIVE GOLD (Au), THICKNESS = 0.6 MICROMETER,
OVER NICKEL, THICKNESS = 1.25 MICROMETER MIN OVERALL
- 3) MATERIAL NUMBER, BATCH CODE UL AND CSA MARKING TO BE PRINTED ON THE CONNECTOR
- 4) CUT FACES OF TIP WITHOUT PLATING PERMITTED
- 5) PRODUCT SPECIFICATION : PS: 36515-001

DETAIL Z DETAIL Y

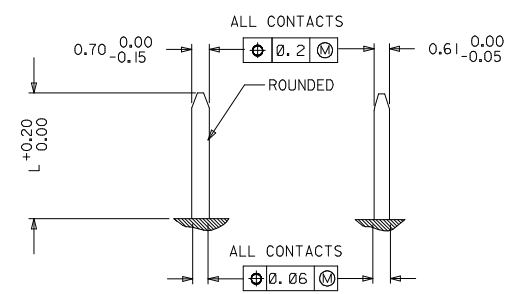

	L
NORMAL CONTACTS	4.8

RoHS COMPLIANT

EC NO: 2007-077Z DRAWN: JAVENG 2008/06/07 CHKD: SUDHR 2008/06/19 APPR: KRASAD 2009/01/22	QUALITY SYMBOLS ▽=0 ▽=0	GENERAL TOLERANCES (UNLESS SPECIFIED) mm INCH 4 PLACES ± --- ± --- 3 PLACES ± 0.05 ± --- 2 PLACES ± 0.1 ± --- 1 PLACE ± 0.15 ± --- ANGULAR ± 2 °	DIMENSION STYLE MM ONLY	SCALE 2:1	DESIGN UNITS METRIC	THIRD ANGLE PROJECTION
	DRAWN BY: SS CHECKED BY: GJLOWE APPROVED BY: GJLOWE DATE: 1999/11/23 DATE: 1999/11/23 DATE: 1999/11/23	TITLE ASSEMBLY, DIN 41612 WITH WIRE WRAP MOLEX INCORPORATED	MATERIAL NO. 36514-0002	DOCUMENT NO. SD-36514-002	SHEET NO. 1 OF 1	

DRAFT WHERE APPLICABLE MUST REMAIN WITHIN DIMENSIONS

THIS DRAWING CONTAINS INFORMATION THAT IS PROPRIETARY TO MOLEX INCORPORATED AND SHOULD NOT BE USED WITHOUT WRITTEN PERMISSION