

ISOMETRIC

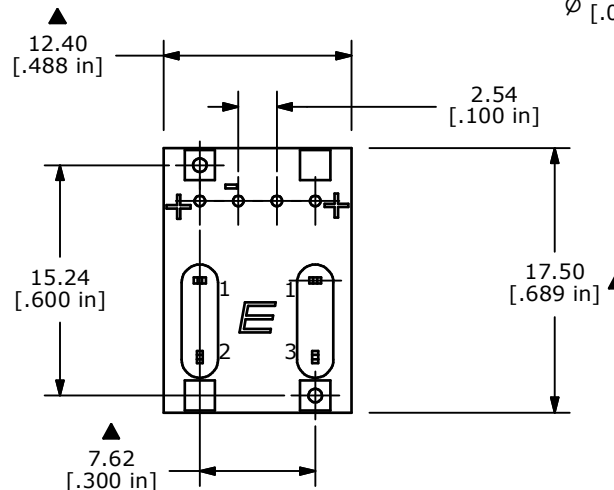

- NOTES:
1. ALL DIMENSIONS IN MM [INCH]
 2. GENERAL TOLERANCE: X.X=±0.4
X.XX=±0.25
 3. TERMINAL NUMBERS FOR REF. ONLY.
 - ▲ 4. RATING: 30mA @ 12VDC
 5. CONTACT RESISTANCE: 50mΩ MAX
 6. INSULATION RESISTANCE: 50MΩ @ 500VDC
 7. DIELECTRIC STRENGTH: 1,000 VAC @ 50/60 Hz FOR 1 min.
 8. OPERATING FORCE: 150± 50gf
 9. TRAVEL: 1.5± 0.3
 10. MECHANICAL LIFE: 500,000 CYCLES
 11. ELECTRICAL LIFE: 30,000 CYCLES
 12. OPERATING TEMPERATURE: -25°C TO 65°C
 13. ▲ DENOTES CRITICAL PARAMETER

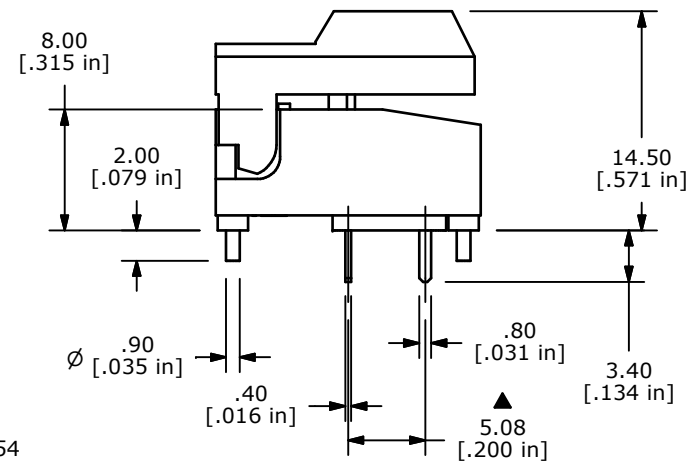
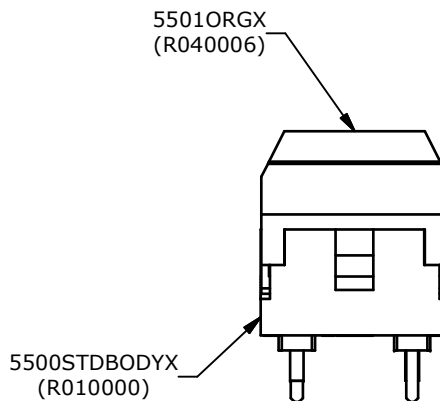
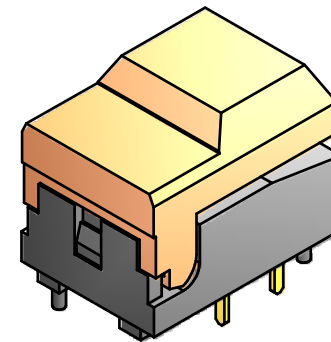

TITLE 5501M6X

A	18611	Released For Production	8/26/09	BLR
REV	PCR NO	DESCRIPTION	DATE	BY

SCALE	DATE	DR	DWG	REV
2:1	8/26/2009	BLR	XR0248P	A

THE INFORMATION CONTAINED IN THIS DOCUMENT IS PROPRIETARY TO E-SWITCH AND IS NOT TO BE COPIED OR TRANSFERRED