

THIS DRAWING IS UNPUBLISHED. RELEASED FOR PUBLICATION  
 © COPYRIGHT BY TYCO ELECTRONICS CORPORATION. ALL RIGHTS RESERVED.

LOC	DIST	REVISIONS			
P	LTR	DESCRIPTION	DATE	DWN	APVD
AF	50	C1	REVISED PER ECR-06-014088	19JUN06	MF KR

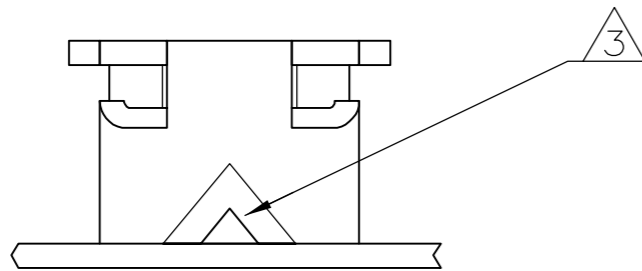

- 1 CONTINUOUS STRIP ON REELS WITH TERMINALS LOCATED ON 5.50±0.08 [.220±.003] CENTERS.
- 2 SLOT ACCEPTS 0.16-0.18mm [#34-#33] AWG COPPER MAGNET WIRE. 2 WIRES OF THE SAME SIZE PER SLOT.
- 3 POKE-IN ACCEPTS A 0.50-0.90mm<sup>2</sup> [#20-#18] AWG SLOID OR FUSED STRANDED LEAD WIRE.
- 4 REELED WITH PAPER ON PLASTIC REEL.
- 5 FOREIGN PRODUCTION ONLY.
- 6 0.002032 [.000080] MIN TIN PLATE.

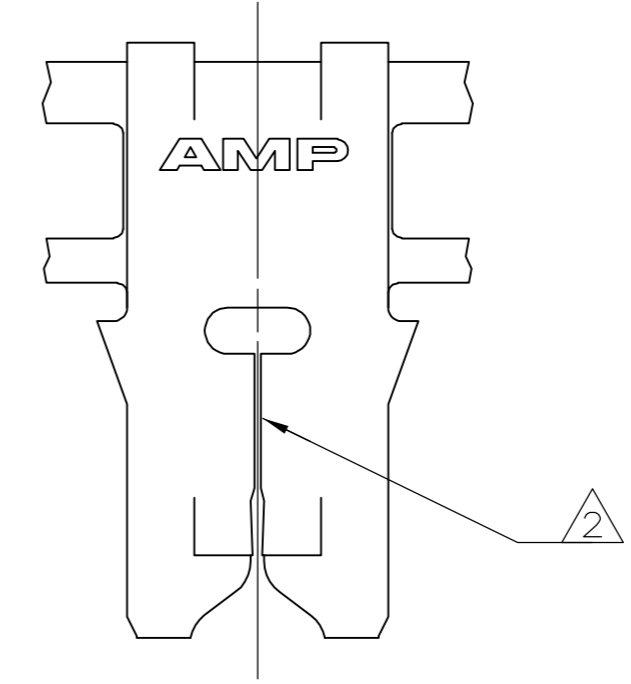
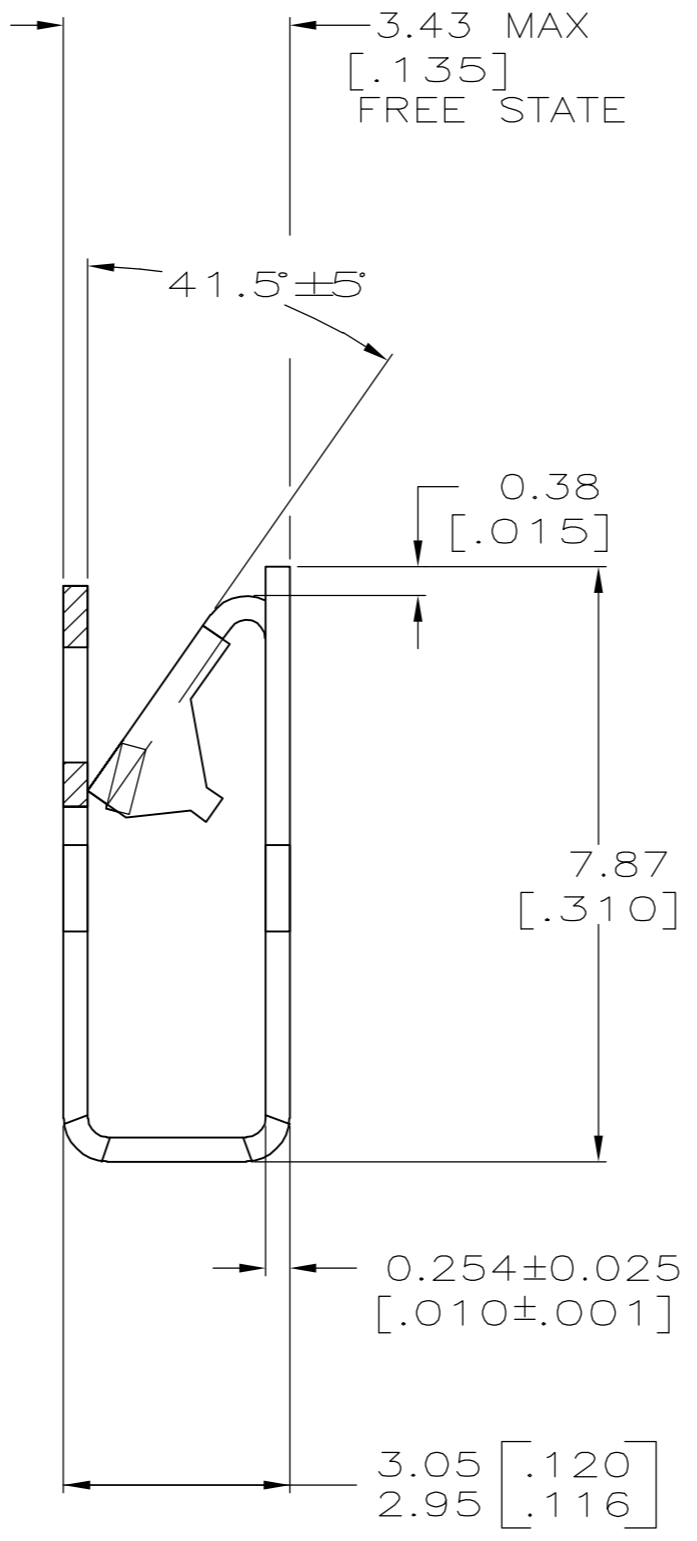
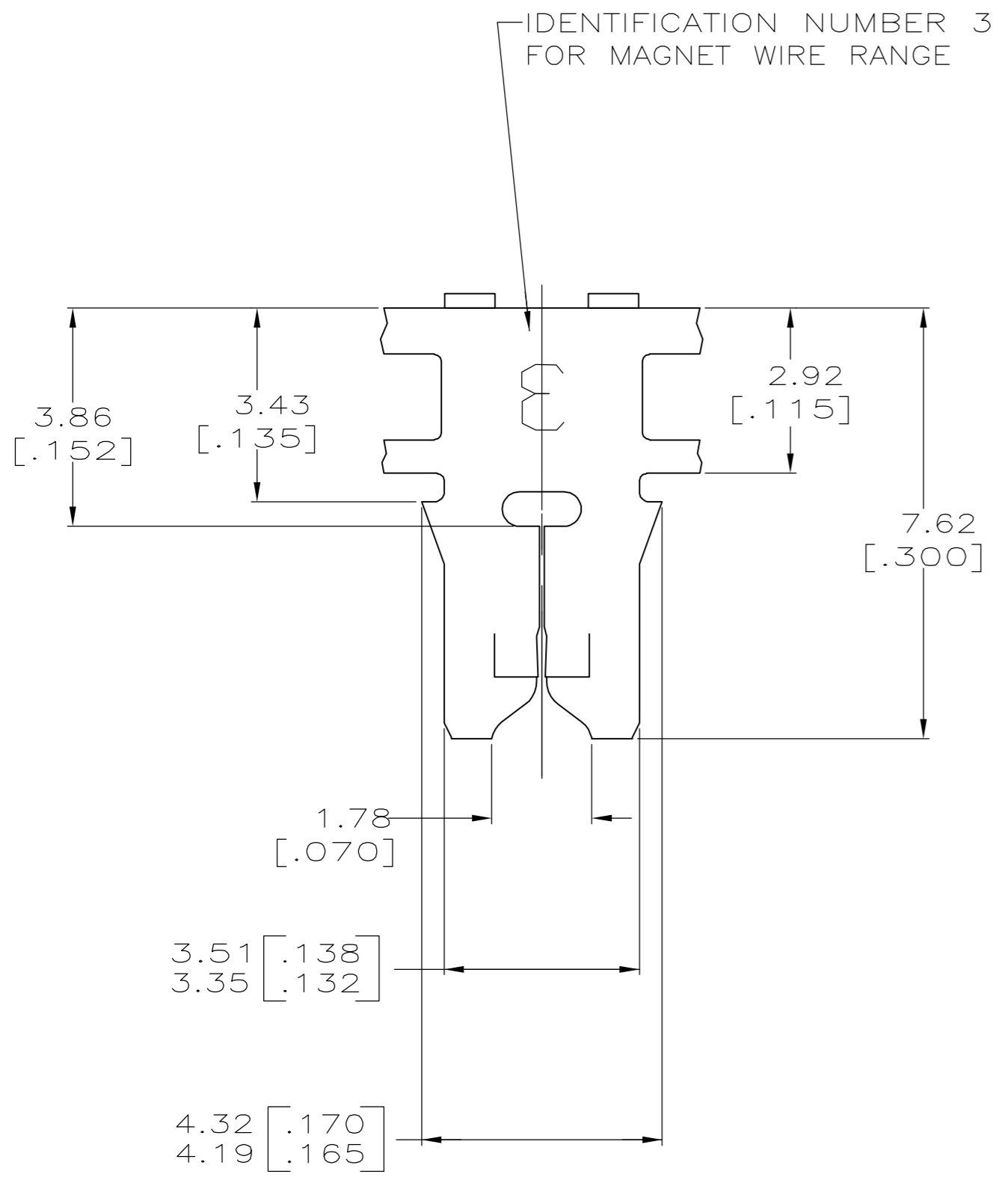

-	4	63662-2	5
6		63662-1	
FINISH		PART NUMBER	

THIS DRAWING IS A CONTROLLED DOCUMENT.		DWN 19JUN2006 MICHAEL S. FEHER	Tyco Electronics Corporation Harrisburg, PA 17105-3608	
DIMENSIONS: INCHES		CHK 19JUN2006 KURT A. RANDOLPH	NAME	
TOLERANCES UNLESS OTHERWISE SPECIFIED:		APVD 19JUN2006 KURT A. RANDOLPH	PRODUCT SPEC	
0 PLC ± -		108-2012		
1 PLC ± -		APPLICATION SPEC		
2 PLC ± 0.25 [.010]		114-2046		
3 PLC ± -		WEIGHT -		
4 PLC ± -		CUSTOMER DRAWING		
ANGLES ± -		SCALE 10:1		
FINISH SEE TABLE		SHEET 1 of 1		
		REV C1		