

# Flush-type connector - SACC-CI-M12MS-17CON-SH TOR 32 - 1457607

Please be informed that the data shown in this PDF Document is generated from our Online Catalog. Please find the complete data in the user's documentation. Our General Terms of Use for Downloads are valid (<http://phoenixcontact.com/download>)



Sensor/actuator flush-type plug, 17-pos. with shroud, A-coded, with straight THR solder connection, contact insert only

## Why buy this product

- Reduced mounting costs thanks to two-piece device connector
- Packaging available for automated pick and place assembly
- All common pin assignments and codings available
- Easy device integration thanks to mechanical port screw connections with threaded attachment, press-in contour or direct integration in the front plate

## Key Commercial Data

|                        |               |
|------------------------|---------------|
| Packing unit           | 100 STK       |
| Minimum order quantity | 100 STK       |
| GTIN                   |               |
| GTIN                   | 4046356617352 |

## Technical data

### Ambient conditions

|                                 |   |
|---------------------------------|---|
| Ambient temperature (operation) | -25 °C ... 85 °C                                |
|                                 | -40 °C ... 85 °C (without mechanical actuation) |
| Degree of protection            | IP67 (correctly plugged in and locked)          |

### General

|                       |  |
|-----------------------|--|
| Note                  | The electrical and mechanical data specified assume that the connector pair is correctly locked and mounted. If the connector is unlocked and if there is a danger of contamination, the connector must be sealed using a protective cap > IP54. Influences arising from litz wires, cables or PCB assembly must also be taken into consideration. |
| Rated current at 40°C | 1.5 A  |
| Rated voltage         | 30 V   |
| Rated surge voltage   | 0.8 kV   |

# Flush-type connector - SACC-CI-M12MS-17CON-SH TOR 32 - 1457607

## Technical data

### General

|                             |                                   |
|-----------------------------|-----------------------------------|
| Number of positions         | 17                                |
| Insulation resistance       | ≥ 100 MΩ                          |
| Coding                      | A - standard                      |
| Standards/regulations       | M12 connector IEC 61076-2-101     |
| Overvoltage category        | III                               |
| Degree of pollution         | 3                                 |
| Test voltage                | 0.8 kV                            |
| Connection method           | THR solder connection             |
| Insertion/withdrawal cycles | > 100                             |
| Torque                      | 3 Nm ... 4 Nm (Installation-side) |
| Mounting type               | PCB mounting                      |
| Type of packaging           | Belt                              |
| Delivery state              | with assembly pad                 |

### Material

|  |      |
|--|------|
| Flammability rating according to UL 94 | V0   |
| Contact material                       | CuZn |
| Contact surface material               | Au   |
| Contact carrier material               | PPA  |
| Sealing material                       | FKM  |

### Cable

|                          |                               |
|--------------------------|-------------------------------|
| Standards/specifications | M12 connector IEC 61076-2-101 |
|--------------------------|-------------------------------|

### Standards and Regulations

|  |                 |
|--|-----------------|
| Standard designation                   | M12 connector   |
| Standards/regulations                  | IEC 61076-2-101 |
| Flammability rating according to UL 94 | V0              |

### Environmental Product Compliance

|            |   |
|------------|---|
| China RoHS | Environmentally Friendly Use Period = 50  |
|            | For details about hazardous substances go to tab "Downloads", Category "Manufacturer's declaration" |

## Drawings

# Flush-type connector - SACC-CI-M12MS-17CON-SH TOR 32 - 1457607

Schematic diagram

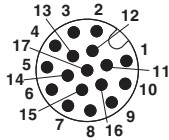

Pin assignment M12 male connector, 17-pos., male side view

Drilling diagram

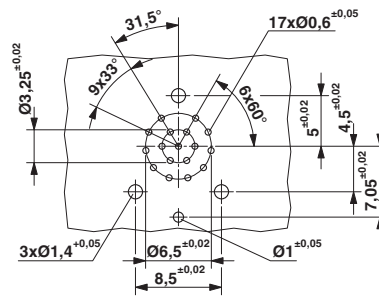

Drilling diagram

Dimensional drawing

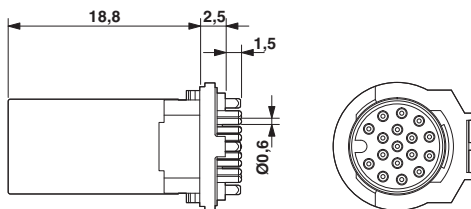

M12 male connector contact carrier

Dimensional drawing

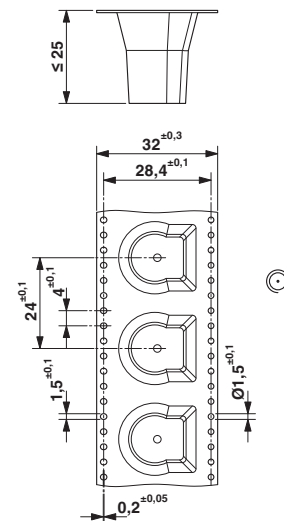

THR tape-on-reel packing

## Approvals

Approvals

Approvals

UL Recognized / EAC

Ex Approvals

## Approval details

# Flush-type connector - SACC-CI-M12MS-17CON-SH TOR 32 - 1457607

## Approvals

|                                |   |   |               |
|--------------------------------|---|---|---------------|
| UL Recognized                  |  | <a href="http://database.ul.com/cgi-bin/XYV/template/LISEXT/1FRAME/index.htm">http://database.ul.com/cgi-bin/XYV/template/LISEXT/1FRAME/index.htm</a> | FILE E 118976 |
| mm <sup>2</sup> /AWG/kcmil     |   | 26-20   |               |
| Nominal current I <sub>N</sub> |   | 1.5 A   |               |
| Nominal voltage U <sub>N</sub> |   | 30 V  |               |

|     |   |               |
|-----|---|---------------|
| EAC |  | EAC-Zulassung |
|-----|---|---------------|

Phoenix Contact 2017 © - all rights reserved  
<http://www.phoenixcontact.com>

PHOENIX CONTACT GmbH & Co. KG  
Flachsmarktstr. 8  
32825 Blomberg  
Germany  
Tel. +49 5235 300  
Fax +49 5235 3 41200  
<http://www.phoenixcontact.com>