

FRONT SHELL

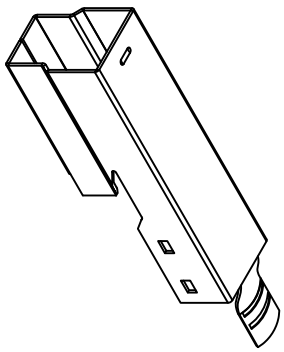

INSERTED BODY

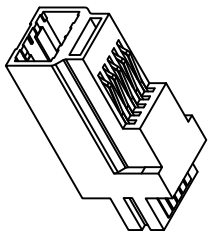

REAR SHELL

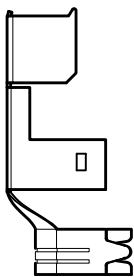
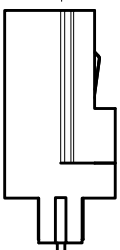
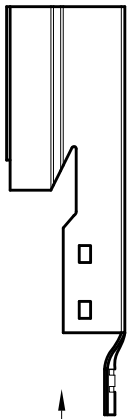
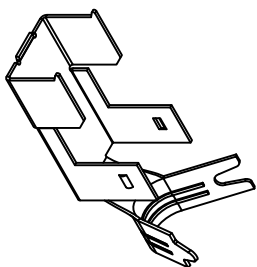

ASSEMBLED PLUG

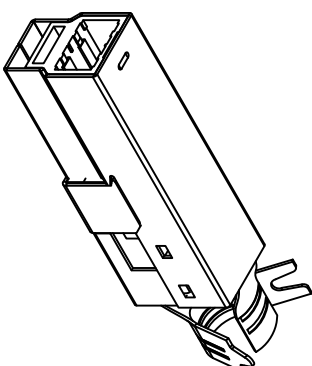

±.032 [±0.81]

1.417 [36.00]

.411 [10.44]

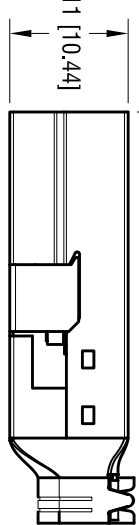

.315 [8.00]

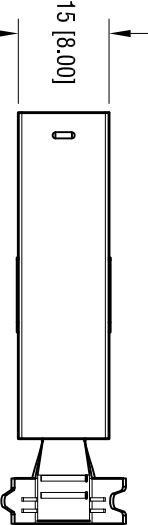

PLUG SPECIFICATIONS:

- SHELL: MAT'L- STEEL
- FINISH- NICKEL PLATE
- INSULATION: MAT'L- THERMOPLASTIC, UL 94V-0
- CONTACT: MAT'L- PHOSPHOR BRONZE
- FINISH- GOLD FLASH OVER NICKEL

ELECTRICAL CHARACTERISTICS:

- RATED VOLTAGE: 30V (RMS)
- CONTACT CURRENT RATING: 1 Amp DC MAX.
- CONTACT RESISTANCE: 15m Ω min.
- DIELECTRIC WITHSTANDING VOLTAGE: 750V AC FOR 1 MINUTE
- MECHANICAL CHARACTERISTICS:
- OPERATING TEMPERATURE: -13°F (-25°C) TO 176°F (+80°C)
- DURABILITY: 1500 CYCLES MIN.

DATE	DESCRIPTION	REV.
5.23.16	CHANGE AS PER ECN 16-060	A
	UPDATE HOUSING	

KEYSTONE ELECTRONICS CORP.
 www.keystone.com • ASTORIA, N.Y. 11105-2017 • Tel (718) 956-8900

PART NAME
 USB 3.0 TYPE B PLUG KIT

MATERIAL
 AS NOTED

FINISH
 AS NOTED

TOLERANCES	INCH	[MM]	CODE	DRN BY	DATE
DECIMAL	± .010	[± 0.25]	C	NT	4.07.10
ANGULAR	± 1°			LN	SCALE 2X
UNLESS OTHERWISE SPECIFIED					
952					

THIS DOCUMENT IS THE PROPERTY OF
 KEYSTONE ELECTRONICS CORP. AND
 SHALL NOT BE REPRODUCED, DISTRIBUTED
 OR USED AS A BASIS FOR MANUFACTURE
 WITHOUT PRIOR WRITTEN PERMISSION
 FROM KEYSTONE ELECTRONICS CORP.