

REV.	DESCRIPTION	DATE
A	RELEASE	2012.11.12

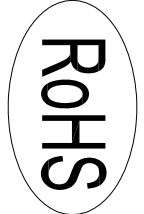

NOTES:
 Insulator Material: PBT, UL 94V-0
 Contact Plating: TIN, 80-100µ"
 Contact Material: Brass

Current Rating : 1A AC,DC
 Contact Resistance: 20MΩ Max.
 Dielectric Withstanding: AC 500V
 Insulator Resistance: 1000MΩ Min.
 Operating Temp.: -40°C~+105°C

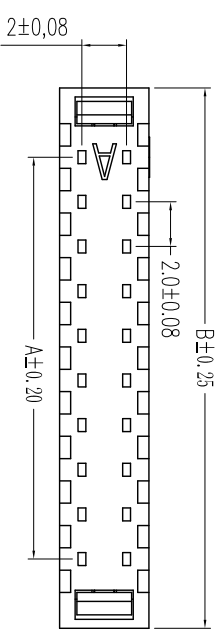
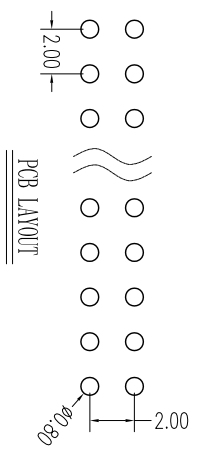
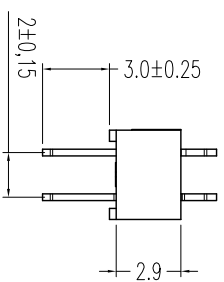
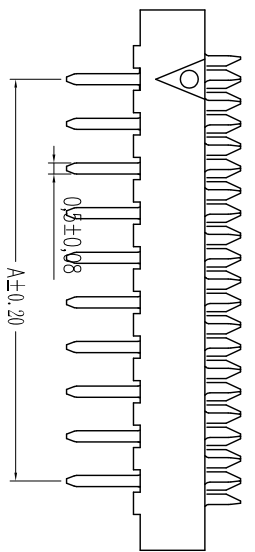
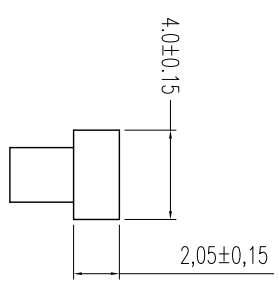
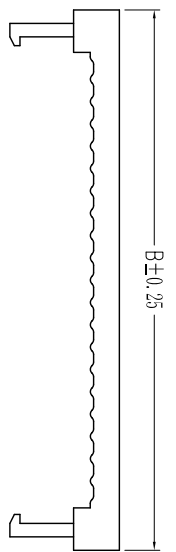
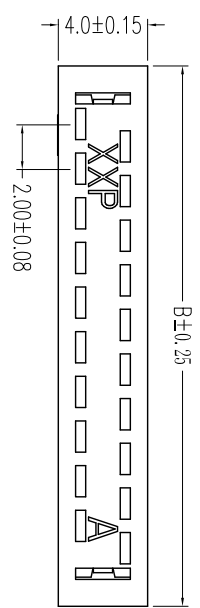

NUMBER OF POSITIONS	DIMENSION	
	A	B
06	4.0	10.2
08	6.0	12.2
10	8.0	14.2
12	10.0	16.2
14	12.0	18.2
16	14.0	20.2
18	16.0	22.2
20	18.0	24.2
24	22.0	28.2
26	24.0	30.2
28	26.0	32.2
30	28.0	34.2
34	32.0	38.2
40	38.0	44.2
44	42.0	48.2
50	48.0	54.2

CnC Tech,LLC

Port NO.:
3140-XX-99

UNLESS TOLERANCE		DRAW	BY
GENERAL	ANGLE	DESIGN	BY
X. ± 0.30	X.° ± 3.0°	CHECK	BY
.X ± 0.20	.XX ± 2.0°	APPROVE	BY
.XX ± 0.15	.XX ± 1.0°	SCALE	SHEET
.XXX ± 0.08	.XXX ± 0.5°	1:1	1/1
		MM	UNIT

