

PRODUCT NUMBER	PITCH
V5xx31x000J0G	3.81mm

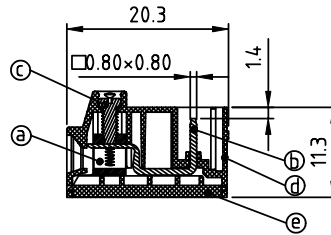
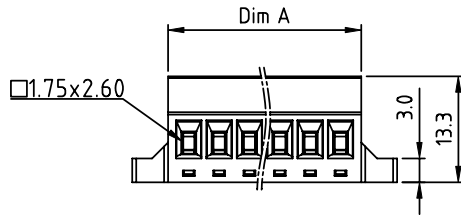
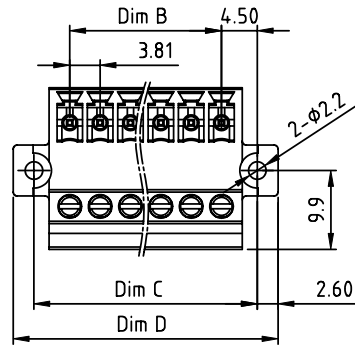

- Material:
- Item (a) Clamp: Brass Ni plated
 - Item (b) Pin: Brass, Tin plated.
 - Item (c) Terminal screw: Steel Zinc plating
 - Item (d) Terminal housing: Thermoplastic (UL94V-0)
 - Item (e) Terminal cover: Thermoplastic (UL94V-0)

- Electrical: cULus
- Voltage rating: 300V
 - Current rating: 8A
 - Wire range:
 - Solid wire(AWG): 14-28
 - Stranded wire(AWG):14-28
 - Torque(Lb-In): 2.17
 - Screw:M2
 - Wire strip length:6 mm
 - Withstanding Voltage:1.6KV
 - Operating temperature: -40°C to +115°C
 - Safety Approval:

N = Number of poles
 Dim A=Nx3.81+1.39
 Dim B=(N-1)x3.81
 Dim C=Nx3.81+5.19
 Dim D=Nx3.81+10.39

Poles	Tolerance
2-6p	±0.15
7-12p	±0.20
13-18p	±0.30
19-24p	±0.35

PART NO.: V5 xx 31 x 0 00J0 G

Solid block	No. of poles	Color	RoHS compliant (lead=4%) In copper Alloy
0	2	Black (RAL9005)	
02	2 poles	Red (RAL3001/D)	
03	3 poles	Orange(RAL2011/P)	
...	...	4 Yellow(RAL1018/A)	
...	...	5 Green(RAL6018/T)	
24	24 poles	6 Blue (RAL5015/A)	
		8 Grey(RAL7035/D)	
		9 White(RAL1102)	
		C Green(RAL6018/U)	

mat'l. code		surface ASME Y14.5	tolerance ASME Y14.5	projection 	product family TERMINAL BLOCK
ltr ecn no dr date		tolerances unless otherwise specified			title TERMINAL BLOCK
		angles $\frac{0}{15}$	X.±0.5	MM	PLUGGABLE PLUG,BOTTOM COVER FIXED TYPE
		$X^{\circ}\pm 1^{\circ}$	X.XX±0.3	scale	dwg no V5xx31x000J0G
		dr EVIN ZHONG 050414	X.XX±0.1		sheet 1 of 1 size A4
		enrg EVIN ZHONG 050414			type CUSTOMER Drawing
		chr HANKE FENG 050414			
		appd SHI JUN 050414			
sheet index	revision sheet	A	1		