

PART NUMBER	REV	FIRST USED
1385440-1	B	122500-1
1385440-2	B	565435-5
1385440-3	B	354500-1

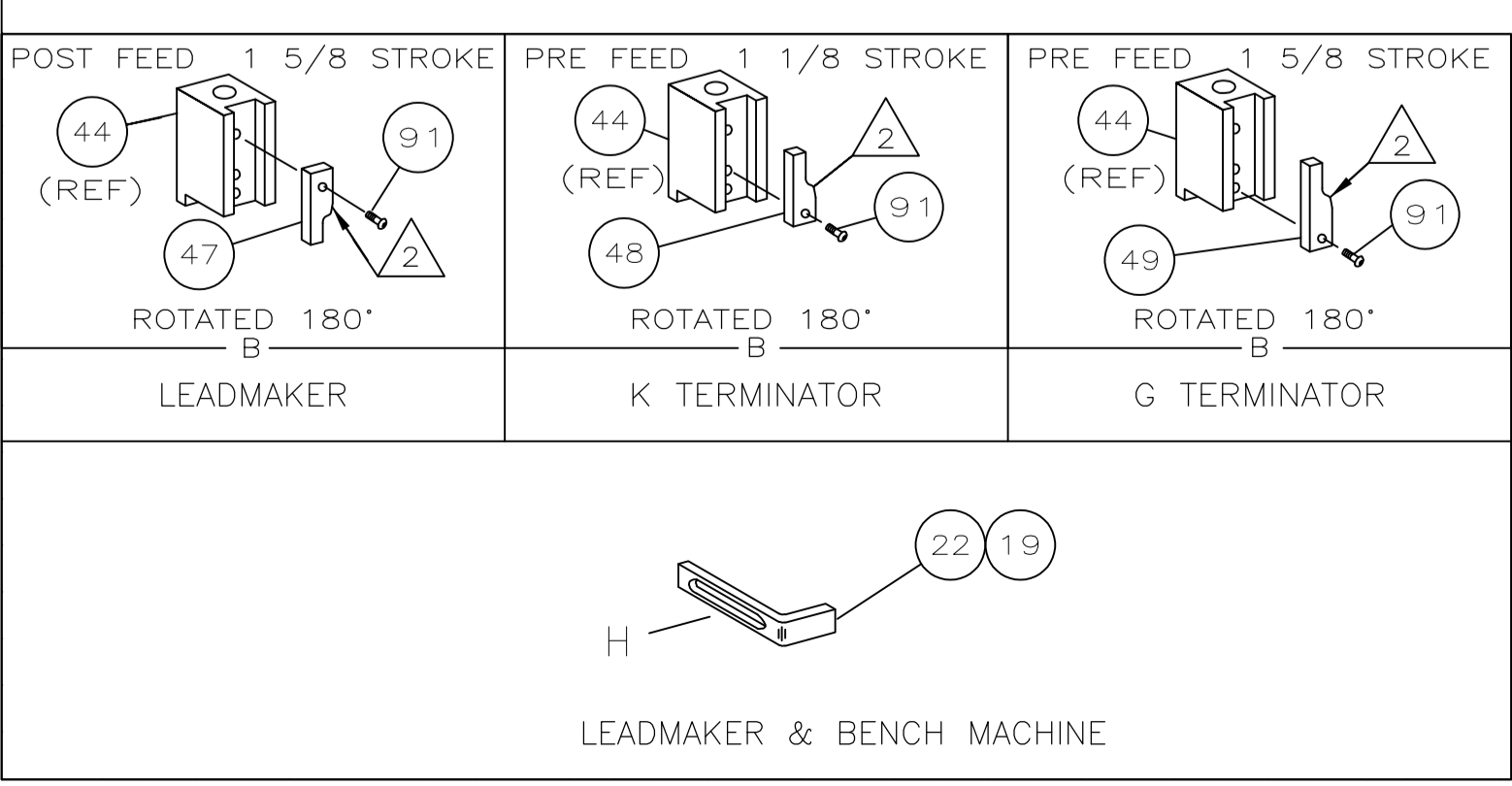
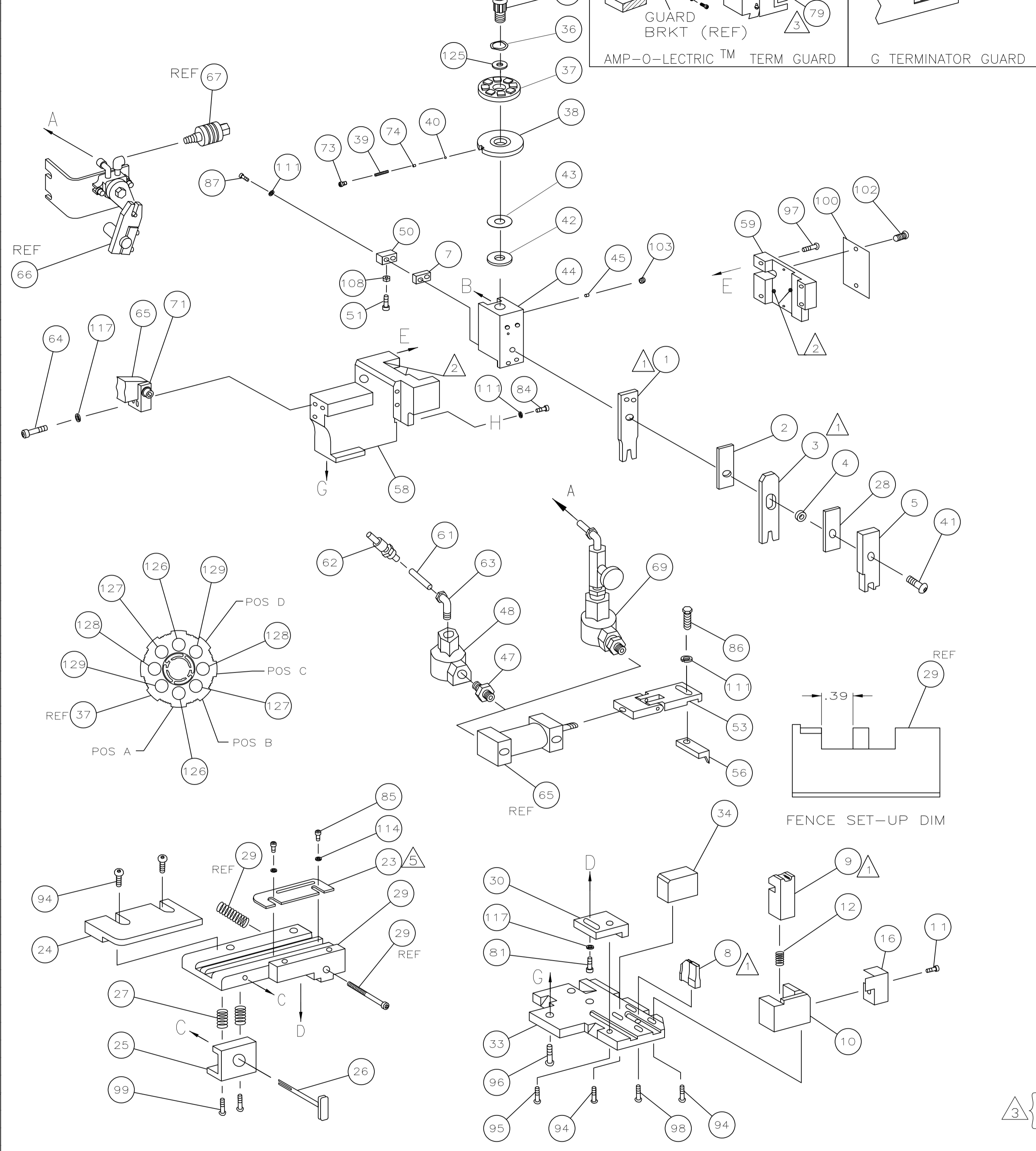

- 1 RECOMMENDED SPARE PARTS.
- 2 GREASE LIGHTLY.
- 3 GUARD MUST BE IN PLACE WHEN OPERATING APPLICATOR IN A BENCH MACHINE.
- 4 SEE DRAWING FOR COMPONENTS
- 5 REVERSE ITEM 23 AS SHOWN.

TERMINAL NAME: STANDARD-TIMER CONTACT

AMP LTR	CRIMP HEIGHT	WIRE SIZE
A	.054 ±.002 [1.36 ±0.05mm]	1mm <sup>2</sup>
B	.052 ±.002 [1.31 ±0.05mm]	.85mm <sup>2</sup>
C	.050 ±.002 [1.27 ±0.05mm]	.75mm <sup>2</sup>
D	.046 ±.002 [1.18 ±0.05mm]	.5mm <sup>2</sup>

CRIMP SIZE	TYPE	RANGE
.080 [2.03mm]	F	.5-1mm

WIRE STRIP LENGTH	TERM APPL SPEC	FEED	APPL INSTRUCTION	SET UP GAGE	LAYOUT
.160-.177	114-18080	.800	408-8040	458637-1	L2679

QTY REQD PER ASSY	PART NO	DESCRIPTION	ITEM NO			
2	2	2	3-354779-0	PIN, WIRE DISC (.3140)D	129	
2	2	2	2-354779-2	PIN, WIRE DISC (.3100)C	128	
2	2	2	1-354779-8	PIN, WIRE DISC (.3080)B	127	
2	2	2	1-354779-4	PIN, WIRE DISC (.3060)A	126	
1	1	1	986950-1	WASHER, FLAT PRECISION	125	
1	1	1	217238-1	GENERAL INSTRUCTION PACKAGE	124	
1	1	1	4088040	SF APPL INST 408-8040	123	
					122	
					121	
					120	
					119	
					118	
3	3	3	21024-5	WASHER, LOCK(#10)ADJ BLOCK	117	
					116	
					115	
2	2	2	21024-2	WASHER,LOCK(#4)FRONT STP GUIDE	114	
					113	
					112	
4	4	4	21024-4	WASHER,LOCK(#8)STRIPPER	111	
					110	
					109	
1	1	1	21018-5	NUT,HEX(NO.6)HOLDDOWN	108	
					107	
					106	
					105	
					104	
1	1	1	21009-2	SCR,SKT SET(1/4-20x.25 LW)RAM	103	
2	2	2	21017-2	SCR,DRIVE(#2x.19)ID PLATE	102	
					101	
1	1	1	461264-1	PLATE, IDENTIFICATION	100	
2	2	2	3-21002-0	SCR,BHC(10-32x.88)DRAG	99	
1	1	1	22733-8	SCR,BHC(8-32x.38 LW)ANVIL	98	
4	4	4	2-21002-9	SCR,BHC(10-32x.75)CAP	97	
3	3	3	2-22733-8	SCR,BHC(1/4-20x.62)HSG	96	
1	1	1	2-21002-7	SCR,BHC(10-32x.50)SG ADJ BLK	95	
6	6	6	2-21002-2	SCR,BHC(8-32x.50)TERM H DWN	94	
					93	
					92	
					91	
					90	
					89	
					88	
					87	
2	2	2	2-21000-8	SCR,SHC(8-32x.62)DEP-HOLD	86	
1	1	1	2-22603-1	SCR,HEX HD(8-32x.38)FEED FINGER	85	
2	2	2	1-21000-3	SCR,SHC(4-40x.25)FR ST GUIDE	84	
1	1	1	2-21000-7	SCR,SHC(8-32x.50)STRIPPER	83	
					82	
1	1	1	3-21000-4	SCR,SHC(10-32x.38)SG ADJ BL	81	
					80	
					79	
-	1	-	462992-7	GUARD ASSY	78	
REF	-	-	679532-1	INSERT, GUARD	77	
					76	
					75	
1	1	1	690603-1	SPRING, ASSIST	74	
1	1	1	23030-1	SCR,SHC(6-32x.25 SL)INS DISC	73	
					72	
1	1	1	459610-3	MOUNT, FEED BRACKET	71	
-3	-2	-1	U/M	PART NO	DESCRIPTION	ITEM NO
PARTS LIST						

LOC	DIST	REV	DESCRIPTION	DATE	DN	APVD
A	66			10-2015	JH	GB

REV	DESCRIPTION	DATE	DN	APVD
-1	LEADMAKER			AIRFEED
-2	BENCH MODEL K			AIRFEED
-3	BENCH MODEL G			AIRFEED

QTY REQD PER ASSY	PART NO	DESCRIPTION	ITEM NO			
-	1	-	692655-5	AIR FEED VALVE ASSY	69	
					68	
					67	
-	REF	-	24042-2	VALVE, SHUT OFF	66	
-	REF	-	692655-6	AIR FEED VALVE ASSY	65	
1	1	1	461065-1	AIR FEED ASSY (1 INCH)	64	
2	2	2	3-21000-7	SCR,SHC(10-32x.75)AIR ASSY	63	
1	-	1	980285-2	ELBOW, SWIVEL 1/8 NPT - 1/4 T	62	
1	-	1	23238-1	QUICK DISCONNECT	61	
21.00	-	21.00	IN	TUBING, POLY-FLO Ø.25	60	
					59	
1	1	1	454220-1	CAP, RAM	58	
1	1	1	454485-1	HOUSING	57	
					56	
					55	
					54	
4	1	1	461062-1	FEED FINGER ASSY	53	
					52	
1	1	1	811242-2	BUMPER, HOLDDOWN	51	
1	1	1	690753-1	SPACER, TONKER	50	
					49	
1	-	1	22374-7	VALVE, QUICK EXHAUST	48	
1	-	1	22304-1	NIPPLE, HEX 1/8 NPT	47	
					46	
1	1	1	690191-1	PLUG, NYLON	45	
1	1	1	455673-1	RAM	44	
1	1	1	690125-1	WASHER, LAMINATED	43	
1	1	1	690124-1	WASHER, RAM	42	
1	1	1	7-21002-9	BOLT, CRIMPER(5/16x1.00)	41	
1	1	1	23241-6	BALL, STEEL	40	
1	1	1	690170-1	SPRING, COMPRESSION	39	
1	1	1	690142-1	DISC, INSULATION	38	
1	1	1	354777-1	WIRE DISC, PLASTIC	37	
1	1	1	22480-5	WASHER, SPRING	36	
1	1	1	690212-1	POST, RAM	35	
1	1	1	690786-1	SUPPORT, TERMINAL	34	
1	1	1	455675-1	PLATE, BASE	33	
					32	
					31	
1	1	1	455689-1	BLOCK, STRIP GUIDE ADJ	30	
1	1	1	318042-1	STRIP GUIDE PLATE ASSY	29	
1	1	1	1-455888-6	SPACER, FRONT SHEAR DEP	28	
2	2	2	1-22284-0	SPRING, DRAG	27	
1	1	1	690546-1	LEVER, DRAG RELEASE	26	
1	1	1	240792-1	DRAG, TERMINAL	25	
1	1	1	1-90765-3	GUIDE, STRIP (REAR)	24	
1	1	1	690438-1	GUIDE, STRIP (FRONT)	23	
-	-	1	690472-2	STRIPPER	22	
					21	
					20	
1	1	-	691353-1	STRIPPER	19	
					18	
					17	
1	1	1	318563-1	GUARD, CHIP, FRONT	16	
					15	
					14	
					13	
1	1	1	3-22280-3	SPRING, SHEAR	12	
1	1	1	690461-1	STOP, SHEAR	11	
1	1	1	690459-1	HOLDER, SHEAR (FRONT)	10	
1	1	1	454276-1	SHEAR, FLOAT (FRONT)	9	
1	1	1	6-662186-9	ANVIL	8	
1	1	1	240641-7	SPACER, DEPRESSOR (REAR)	7	
					6	
1	1	1	1-455889-4	DEPRESSOR, SHEAR (FRONT)	5	
1	1	1	1-238011-0	SPACER, BLOCK CRIMPER	4	
1	1	1	1-854830-5	CRIMPER, INSULATION	3	
1	1	1	455888-5	SPACER, CRIMPER	2	
1	1	1	1-456405-5	CRIMPER, WIRE	1	
-3	-2	-1	U/M	PART NO	DESCRIPTION	ITEM NO
PARTS LIST						

THIS DRAWING IS A CONTROLLED DOCUMENT.

DIMENSIONS: INCHES	TOLERANCES UNLESS OTHERWISE SPECIFIED:	0 PLC ± .005	1 PLC ± .002	2 PLC ± .002	3 PLC ± .002	4 PLC ± .002	ANGLES ± .005
--------------------	----------------------------------------	--------------	--------------	--------------	--------------	--------------	---------------

MATERIAL	FINISH	WEIGHT	SIZE	CAGE CODE	DRAWING NO	RESTRICTED TO
			A1	00779	1385440	

CUSTOMER DRAWING SCALE - SHEET 1 of 1 REV B2

TE Connectivity Harrisburg, PA 17105-3608

SIDE FEED HDM APPLICATOR