

# 21000N series

Low profile toggle switches



## DISTINCTIVE FEATURES

Threaded or plain bushing, with mounting plate

Low profile

Same height for single and double pole

Wave solderable only



## ELECTRICAL SPECIFICATIONS

- Max. current/voltage rating with resistive load :
  - silver contacts (A) : 4 A 30 VDC
  - gold plated brass contacts (LD) : 100 mA 30 VDC
- Minimum load :
  - silver contacts (A) : 100 mA 10 V
  - gold plated brass contacts (LD) : 10  $\mu$ A 5 VDC - 10 mA 50 mV
- Initial contact resistance : 20 m $\Omega$  max.
- Insulation resistance : 1,000 M $\Omega$  min. at 500 VDC
- Dielectric strength :
  - 1,000 Vrms 50 Hz min. between terminals
  - 2,000 Vrms 50 Hz min. between poles
  - 2,000 Vrms 50 Hz min. between terminals and frame
- Electrical life at full load :
  - silver contacts (A) : 20,000 cycles
  - gold plated brass contacts (LD) : 50,000 cycles



## GENERAL SPECIFICATIONS

- Low level or mechanical life : 100,000 cycles.
- Operating temperature : -40 °C to +85 °C (-40 °F to +185 °F)



## MATERIALS

- Case and cover : PBT
- Actuator : brass, nickel plated
- Bushing : brass, nickel plated
- Contacts : **A** : silver, **LD** : brass, gold plated
- Terminal seal : epoxy

APEM products may be recycled at end-of-life for the re-claiming of valuable metal components.

The company reserves the right to change specifications without notice.



# 21000N series

Low profile toggle switches



## PANEL CUT-OUT

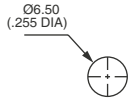

## ELECTRICAL FUNCTIONS

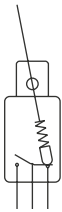

## PCB MOUNTING

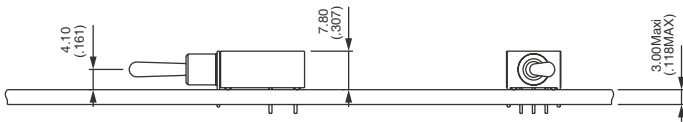

## POSITIONS AND CONNECTIONS

Bottom view	III	II	I
Function 6	ON	-	ON
Function 9	ON	OFF	ON
Function 7	MOM	OFF	MOM
Function 8	ON	OFF	MOM
Function 2	ON	-	MOM

# 21000N series

Low profile toggle switches



## BUILD YOUR PART NUMBER

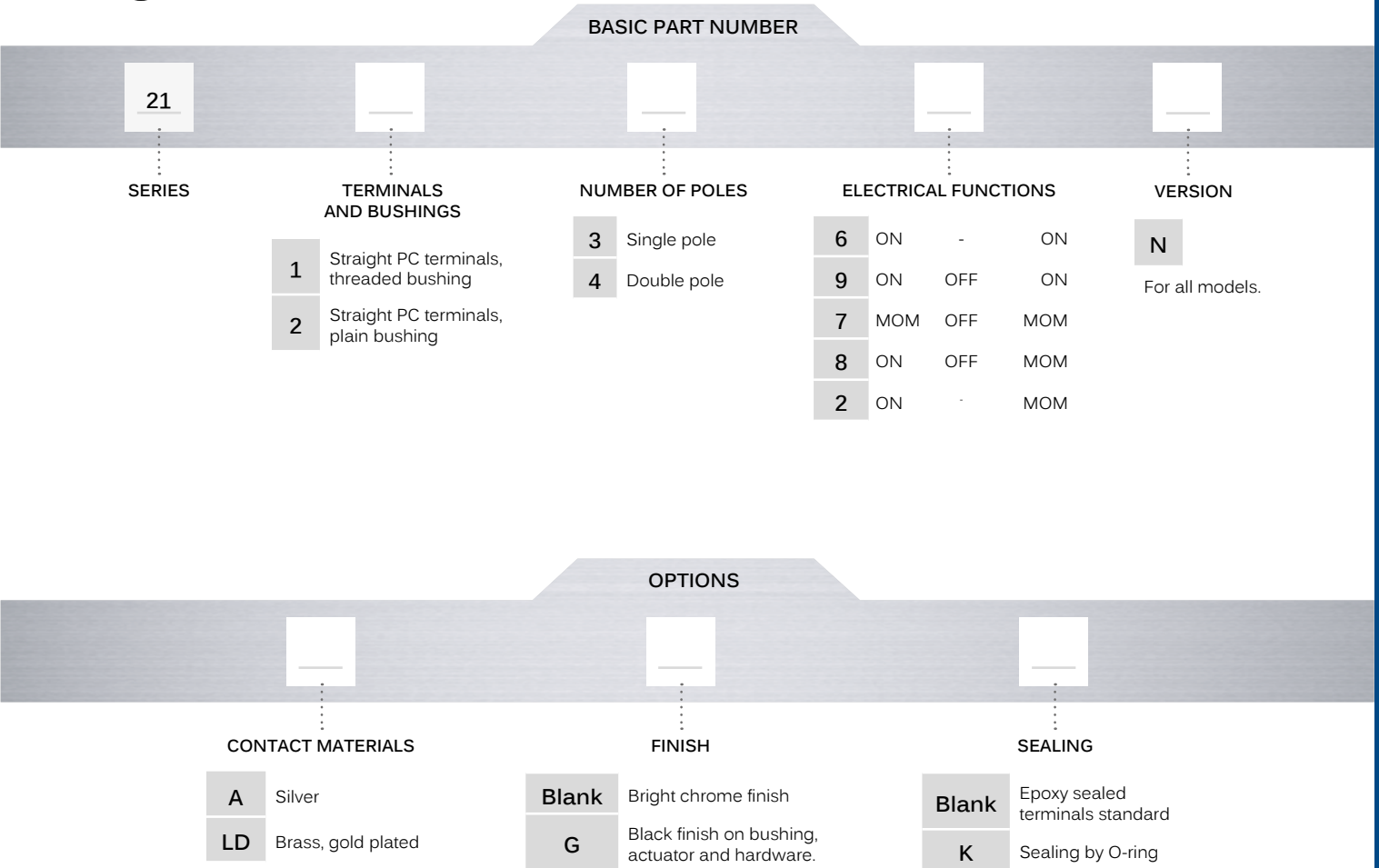

## ABOUT THIS SERIES

On the following pages, you will find successively basic part numbers of switches and options in the same order as in above chart.

- ⚠ **Notice** : please note that not all combinations of above numbers are available. Refer to the following pages for further information.
- ⚠ **Mounting accessories** : standard hardware supplied with all models with threaded bushing : 2 hex nuts 8 mm (.314) across flats. Standard and special hardware available is presented in the "Hardware" section of website.



# 21000N series

Low profile toggle switches

## CONTACT MATERIALS



- A Silver
- LD Brass, gold plated

## FINISH



- Blank Nickel plating on bushing, actuator and hardware.
- G Black finish on bushing, actuator and hardware.

## SEALING

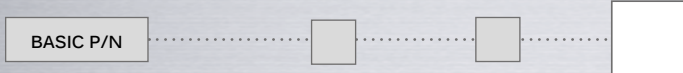

Epoxy sealed terminals are standard.

**Blank** No sealing except standard.

**K** Bushing internally sealed by one O-ring (version without washer U360). Protects the switch against water and dust.

