

PLEASE CHECK WWW.MOLEX.COM FOR LATEST PART INFORMATION

Part Number: [63813-9500](#)
Status: **Active**
Description: Extractor Tool for MOX, 0.63mm Receptacle Crimp Terminals

Documents:
[RoHS Certificate of Compliance \(PDF\)](#)

General

Product Family	Application Tooling
Series	T0201
Function	Extraction
Geographic Area	Global
Level of Automation	Manual
More Detailed Tech Information	applicationtooling@molex.com
Product Name	N/A
Survey	www.molex.com//review/apptool_survey.html
Tool Type	Handtool
UPC	884982407350

Material Info

Reference - Drawing Numbers

Application Tooling Documents	ATS-638139500
-------------------------------	---------------

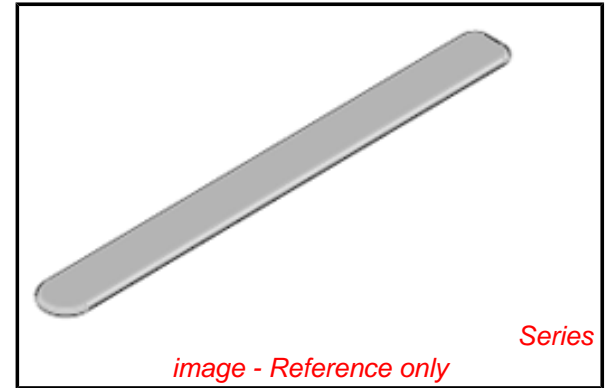

EU RoHS	China RoHS
Compliance Status	
Not Reviewed	
REACH SVHC	
Not Reviewed	
Low-Halogen Status	
Not Reviewed	

Need more information on product environmental compliance?

Email productcompliance@molex.com
 For a multiple part number RoHS Certificate of Compliance, [click here](#)

Please visit the [Contact Us](#) section for any non-product compliance questions.

Search Parts in this Series

[T0201Series](#)

Use With

[98495 35 Circuit Hybrid Female Receptacle Housing](#)

Application Tooling	FAQ
Description	Product #

2.54mm Pitch MOX FFC/FPC Crimp Terminal, Female, 0.635mm , Reel, Tin (Sn), Crimp	0981941211
NSCC Receptacle Terminal Size 1.5, Wire Size 0.22 up to 0.44mm2	0988971109
NSCC Receptacle Terminal Size 1.5, Wire Size 0.49 up to 0.94mm2	0988971119
NSCC Receptacle Terminal Size 1.5,	0988971129

Wire Size 0.95 up to
1.87mm²

This document was generated on 10/04/2012

PLEASE CHECK WWW.MOLEX.COM FOR LATEST PART INFORMATION